

66 Series Parts List

Item	Part #	Description
1	83602-D	Waste Tube (direct drain only)
2	83603	Tailpiece
3	13673	Direct Drain Tee
4	11508	Fulcrum Linkage Asm.
5	80215	Waste Elbow (66 Series)
6	13810	Gasket
7	80142	Chrome Plated Flange
8	80189	Chrome Plated Stopper
9	88152	Bright Brass Flange
10	88123	Bright Brass Stopper
11	88084	Antique Brass Flange
12	88083	Antique Brass Stopper
13	83602	Waste Tube
14	80255	Waste Tee
15	14202	Waste Flange Wrench
16	13105	Spring Linkage
17	11177	Eye Bolt
18	11827	Hex Nut
19	11505	Adjusting Link
20	12010	Cotter Pin
21	13610	Low er Tube (Slip Joint)
22	12214	O-Ring (Slip Joint)
23	88124	Round Chrome Face Plate Asm.
24	80029	Chrome Octagon Face Plate Asm.
	12472	Chrome Face Plate Screw
25	89064	Bright Brass Face Plate Asm (Rnd)
	81065	Bright Brass Face Plate Screw
26	89004	Antique Brass Face Plate Asm. (Oct)
	82482	Antique Brass Face Plate Screw
27	13650	Overflow Elbow
28	13850	Beveled Washer
29	83609	Overflow Tube (short)
30	83636	Overflow Tube (Long)
31	11515	Double "I" Link (w hirlpool only)
32	10839	Plunger Guide (w hirlpool only)
33	80275	Cast Elbow (Direct Drain only)
34	80265	Cast Brass Tee (Side Outlet)
35	13906	Slip Joint Washer
36	11824	Slip Joint Nut
37	83665	Tube Elbow (Side Outlet Drain Only)

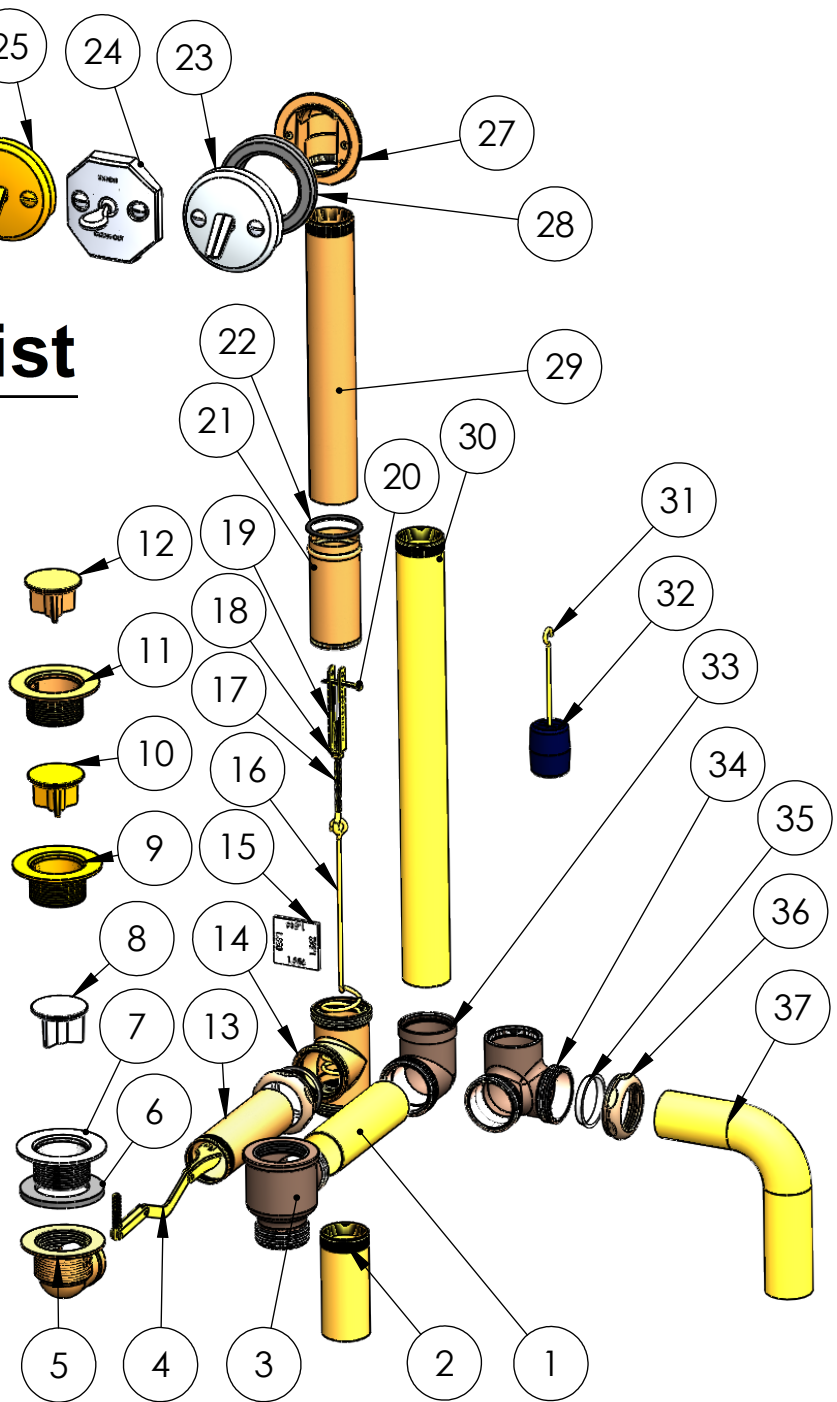

For more information contact:

UNION BRASS MANUFACTURING COMPANY

2955 Lone Oak Circle, Eagan, MN 55121

Phone (651) 454-8858 Fax (651) 454-1228

WWW.UNIONBRASS.COM