

Model
632-AQC

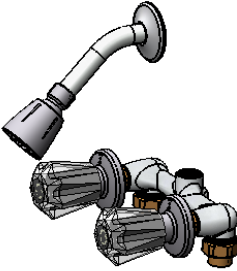

Model
632-EC



Model
633-AC

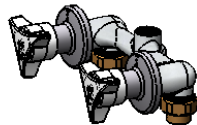
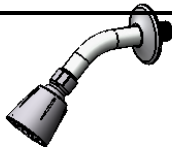
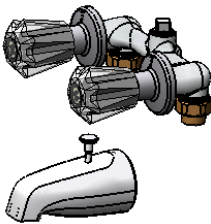

Model
634

632 Series 6" shower Behind The Wall



Features : Cast Brass Body

Ceramic or Compression Valves

Renewable Seats

Adjustable Showerhead

1/2" Pipe or 1/2" Copper Connections

1/2" to 2 & 3/8" Wall Thickness

Model #	Description	Handle	Valve	Spout
632	Twin Ell	Metal	Comp	Zinc
632-C	Twin Ell	Metal	Comp	Cast Brass
632-Q	Twin Ell	Metal	1/4 Turn	Zinc
632-QC	Twin Ell	Metal	1/4 Turn	Cast Brass
632-A	Twin Ell	Acrylic	Comp	Zinc
632-AC	Twin Ell	Acrylic	Comp	Cast Brass
632-AQ	Twin Ell	Acrylic	1/4 Turn	Zinc
632-AQC	Twin Ell	Acrylic	1/4 Turn	Cast Brass
632-E	Ejector	Metal	Comp	Zinc
632-CE	Ejector	Metal	Comp	Cast Brass
632-QE	Ejector	Metal	1/4 Turn	Zinc
632-QCE	Ejector	Metal	1/4 Turn	Cast Brass
632-AE	Ejector	Acrylic	Comp	Zinc
632-ACE	Ejector	Acrylic	Comp	Cast Brass
632-AQE	Ejector	Acrylic	1/4 Turn	Zinc
632-AQCE	Ejector	Acrylic	1/4 Turn	Cast Brass
633	Tub only	Metal	Comp	Zinc
633-C	Tub only	Metal	Comp	Cast Brass
633-Q	Tub only	Metal	1/4 Turn	Zinc
633-QC	Tub only	Metal	1/4 Turn	Cast Brass
633-A	Tub only	Acrylic	Comp	Zinc
633-AC	Tub only	Acrylic	Comp	Cast Brass
633-AQ	Tub only	Acrylic	1/4 Turn	Zinc
633-AQC	Tub only	Acrylic	1/4 Turn	Cast Brass
634	Shower only	Metal	Comp	N/A
634Q	Shower only	Metal	1/4 Turn	N/A
634A	Shower only	Acrylic	Comp	N/A
634AQ	Shower only	Acrylic	1/4 Turn	N/A

American Craftsmanship Since 1892

When Ordering Specify Complete Model Number