

UNION BRASS®

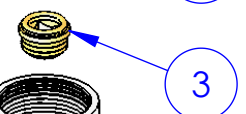

602 & 604 Parts breakdown / Description

Item #	Part #	Description
1	86004	Body for 3/8 Npt Casting
2	86004	Body for 3/8 Npt Casting
3	12643	Seat
4	13805	Bib Washer
5	80049	Valve Assembly without handle
6	82701	Bearing plate assembly
7	15119	Cross Handle
8	80950	Lever Handle
9	97740	Plain Handle Cap
10	97738	Hot Handle Cap
11	97739	Cold Handle Cap

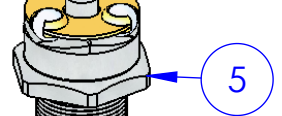
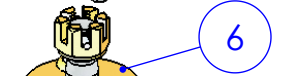
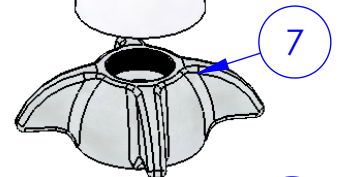
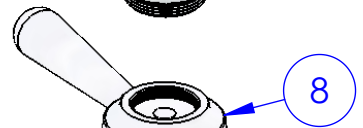
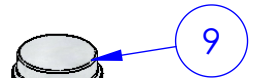
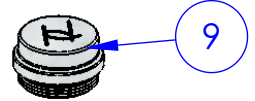
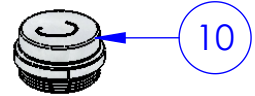
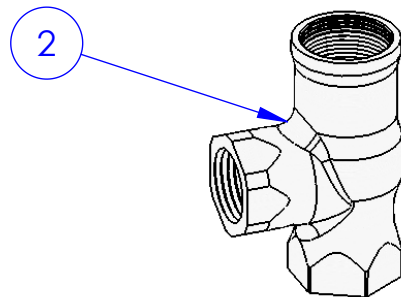
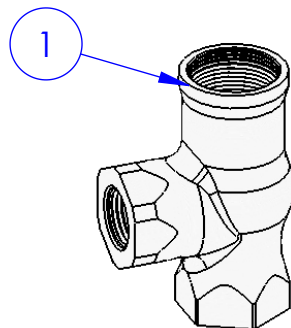

For more information contact:

UNION BRASS MANUFACTURING COMPANY

2955 Lone Oak Circle, Eagan, MN 55121

Phone (651) 454-8858 Fax (651) 454-1228

WWW.UNIONBRASS.COM