

172 Parts and Description

Item #	Part #	Description
1	12461	Handle Screw
2	80351	Hot Handle Assembly
3	80037	Hot Compression Valve
4	13801	Bib Washer
5	80079-LS	Hot 1/4 Turn Ceramic Valve
6	89155	Slantback Left 1/4 Turn Assy
7	89153	Slantback Left Compression Assy
8	11801	Coupling Nut
9	89135	Spout and Aerator Assembly
10	12221	Spout O-Ring
11	11195	Spout Escutcheon
12	89137	Slantback Tee Assy (less screw)
13	11169	Escutcheon
14	15325	Notched Nut
15	13845	Compression Sleeve
16	15326	Compression Nut
17	12472	Hold Down Screw
18	9004	Popup Assembly
19	80352	Cold Handle Assembly
20	80038	Cold Compression Valve
21	13717	Fibre Washer
22	12642	Renewable Long Seat
23	10711	Male Aerator
24	89154	Slantback Right Compression Assy
25	80080-LS	Cold 1/4 Turn Ceramic Valve
26	89155	Slantback Right 1/4 Turn Assy

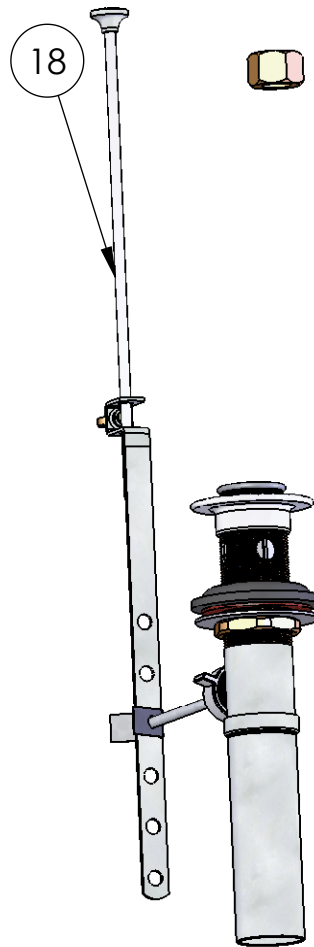

UNION BRASS MANUFACTURING COMPANY

2955 Lone Oak Circle, Eagan, MN 55121

Phone (651) 454-8858 Fax (651) 454-1228 WWW.UNIONBRASS.COM